

TOWN SQUARE S/C SOUTH HILL, VA

6/26/97
SCALE
0 50 100 200



ADJOINING
PARCEL
4.0 +/- ACRES

PARCEL #6
14.18 ACRES

I-85 SOUTH BOUND

PARCEL #5
1.72 ACRES

ADJOINING
PARCEL
8.0 +/- ACRES

PARCEL #2
2.32 ACRES

I-85 EXIT RAMP

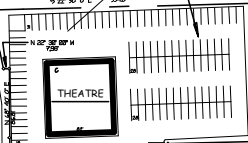
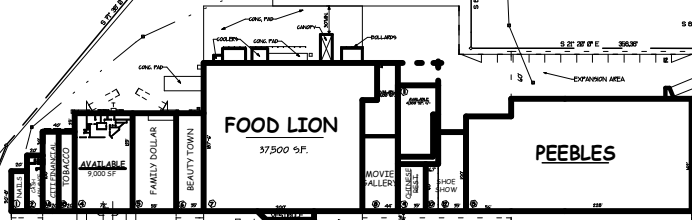

PARCEL #4
0.13 ACRES

PIZZA HUT HARDEE'S

PARCEL #3
0.01 ACRES

AUTOZONE

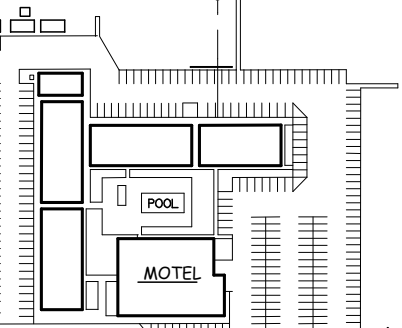

KFC & TACOBELL

TRADING

RESTAURANT

US HWY. #58 BUSINESS WEST BOUND

U.S. HWY 58

TRAFFIC LIGHTS

TO I-85 & 58 BYPASS

ROSES & CVS McDONALDS GAS STATION